

No. 06221**Paper has jammed in the Paper Advance Unit.****Error message release**

YES

Condition

Suffix number	Condition
00001	The paper sensor 1 does not turn LIGHT even though the paper was fed to the paper advance unit 1.
00002	The paper sensor 2 (left) does not turn DARK even though the paper was fed to the processor loading unit.
00003	The paper sensor 2 (center) does not turn DARK even though the paper was fed to the processor loading unit.
00004	The paper sensor 2 (right) does not turn DARK even though the paper was fed to the processor loading unit.

Check Point

1	Confirm that each sensor is not dirty.
2	Confirm that the pressure guide of the paper advance unit 2 is correctly attached.
3	Carry out Paper Sensor LED Light Intensity Adjustment in Functions of Paper Sensor Adjustment . ☞ 36000

**IMPORTANT**

- If the error of the suffix number 00002, 00003 or 00004 is shown, confirm that the rollers of the paper advance unit 2 and the processor loading unit are not dirty.

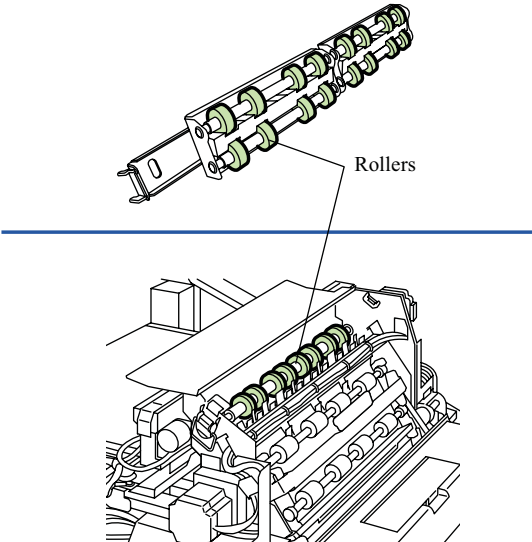
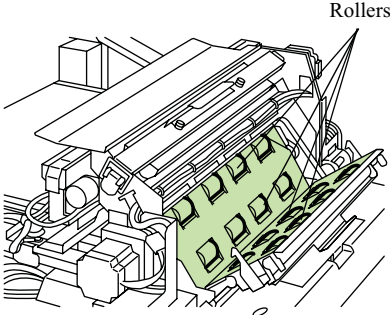
Paper advance unit 2	Processor loading unit
	

- If the suffix numbers 00002, 00003 or 00004 is shown, confirm that the spring 2 of paper advance unit 1 is not broken.

Paper advance unit 1

Spring 2

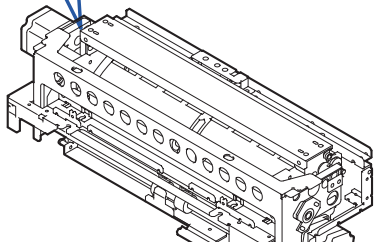
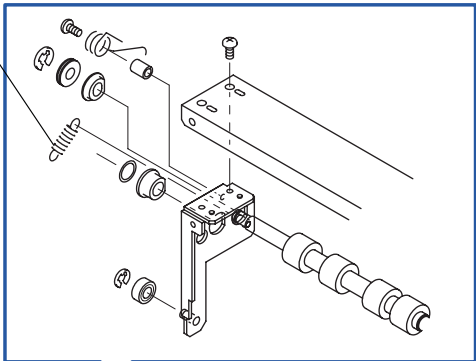

G078460

Diagnosis

Detection failure	Manual No.
Paper sensor 1	63090
Paper sensor 2 (left, center or right)	63110
Printer I/O PCB 3	66040
Printer control PCB	66000

◆ Symptoms due to connection failure of wiring/symptoms resulted from blowout of fuse

Symptoms due to the wiring connection failure	Symptoms of fuse blowout
4202	—

NOTE

- To access the wiring diagrams, click **Wiring diagrams** in Bookmarks.